

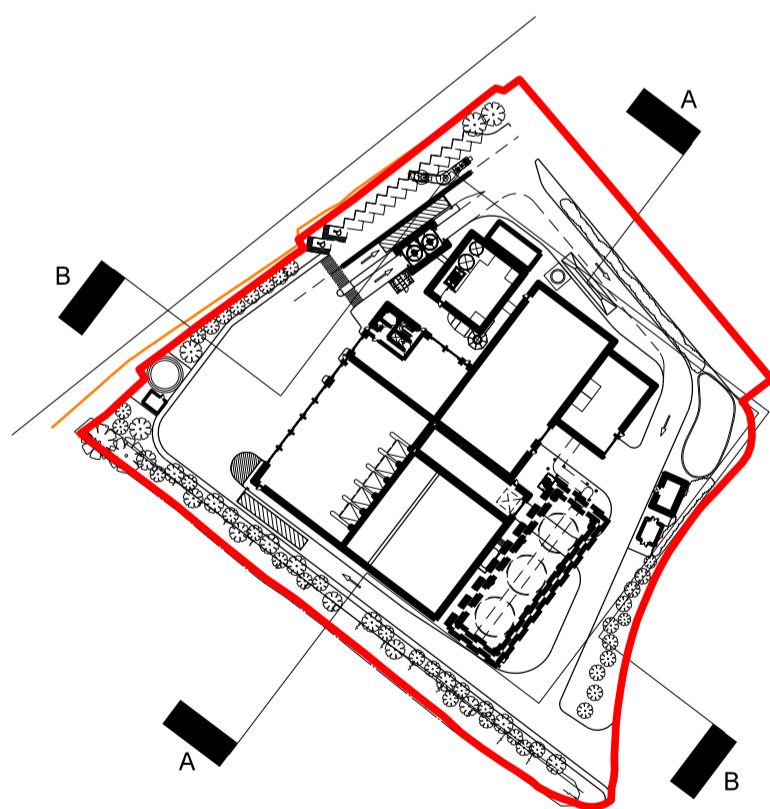

Section AA, Through The Site Looking North West



Section BB, Through The Site Looking South West



SECTION KEY

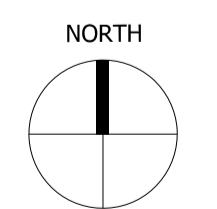

0 10 25m

NOTE

1. THIS DRAWING IS COPYRIGHT GSDA LTD.
2. THE CONTRACTOR MUST NOT SCALE FROM THE DRAWING ALL DIMENSIONS TO BE TAKEN FROM DIMENSION STRINGS.
3. WHERE ANY DISCREPANCIES ARE FOUND BETWEEN DIMENSIONS THESE MUST BE BROUGHT TO THE ATTENTION OF THE ARCHITECTS FOR RESOLUTION.
4. WHERE DISCREPANCIES EXIST BETWEEN REFERENCE OR ASSEMBLY DRAWINGS & DETAIL DRAWINGS, THE LATTER TAKE PREFERENCE.

|              |          |                        |          |  |  |
|--------------|----------|------------------------|----------|--|--|
| PROJECT      |          | MÖR HAFREN ERF         |          |  |  |
| DRAWING      |          | Proposed Site Sections |          |  |  |
| FOR PLANNING |          | -                      | 19/11/13 | Issued for planning                        |  |
| 1:250@A0     | 20/08/24 | A                      | 20/08/24 | Positioning of south western fence revised |  |
| SCALE        | DATE     |                        |          |  |  |
| 1383 PL201   | A        |                        |          |  |  |
| DWG. NO.     | REVISION |                        |          |  |  |

**GSDA**  
GARRY STEWART DESIGN ASSOCIATES  
Highlands House, Office 300A, 165 The Broadway, Wimbledon, London, SW19 1NE  
T. 020 8544 8085